

---

PARK HYATT MALLORCA™

---





# PARK HYATT MALLORCA

A LUXURY RETREAT REFLECTING  
THE STYLE OF A TRADITIONAL MA  
JORCAN HILLTOP VILLAGE  
WITH REFERENCES TO LOCAL ART  
AND CULTURAL HERITAGE



# RESIDENTIAL DESIGN

## A HOME AWAY FROM HOME

- 126 oversized guestrooms (50 square meters) Each space features furnished terraces.
- 14 suites and 2 presidential suites, which range from 100 to 150 square meters, with a Jacuzzi in the terrace in the case of the presidential suites.



# ELEGANT EVENT SPACES

---

SPACES THAT INSPIRE







# THE PARK BALLROOM

## PARK HYATT BALLROOM

A stunning 225 m<sup>2</sup> salon located in a separate building with a large reception area and a breathtaking terrace.

## BALLROOM TERRACE

An extensive terrace (190 m<sup>2</sup>) with a stunning backdrop overlooking the Canyamel Valley.

The perfect venue for social occasions to large events including presentations and product launches.







## CAP VERMELL RESIDENCES

Introducing a unique meeting concept, the Residences is a collection of seven elegant yet versatile event and meeting spaces with natural daylight, connected by a tiled courtyard with stone mosaics, “The Patio”, perfect for coffee breaks and social drinks, featuring a central fountain.

## CANOSTRA

An exclusive meeting space of 128 m<sup>2</sup> and capacity for up to 100 guests, where chefs may interact with participants.

Perfect for team-building activities and cooking competitions.





# AUTHENTIC CUISINE

A TRUE TASTE OF MALLORCA







## 4 RESTAURANTS

- **TAPAS BAR** offers a sociable dining experience and a mouth-watering menu emphasizing the genuine flavors of Spanish gastronomy.
- **ASIA** is an exquisitely designed space serving Southeast Asian delicacies.
- In **CAFÉ SA PLAÇA** you can enjoy a relaxed atmosphere, surrounded by local Majorcan artwork and the aroma of freshly baked bread and cakes as well as an exquisite selection of local dishes.
- **BALEARIC**: Savor Spanish and Majorcan cuisine made using only fresh ingredients sourced primarily from neighboring farms and fishing ports.



A scenic view of a coastline with turquoise water, green hills, and buildings. The water is a vibrant turquoise color, and the hills are covered in lush green vegetation. In the background, there are several buildings, possibly a resort or a small town, nestled on the hillside. The sky is a clear blue with some light clouds. The overall scene is bright and sunny, suggesting a beautiful day in a tropical or Mediterranean location.

# A PRIVILEGED LOCATION

---

REVEL IN THE UNFORGETTABLE P  
LEASURES OF MALLORCA

---



# AREA MAP

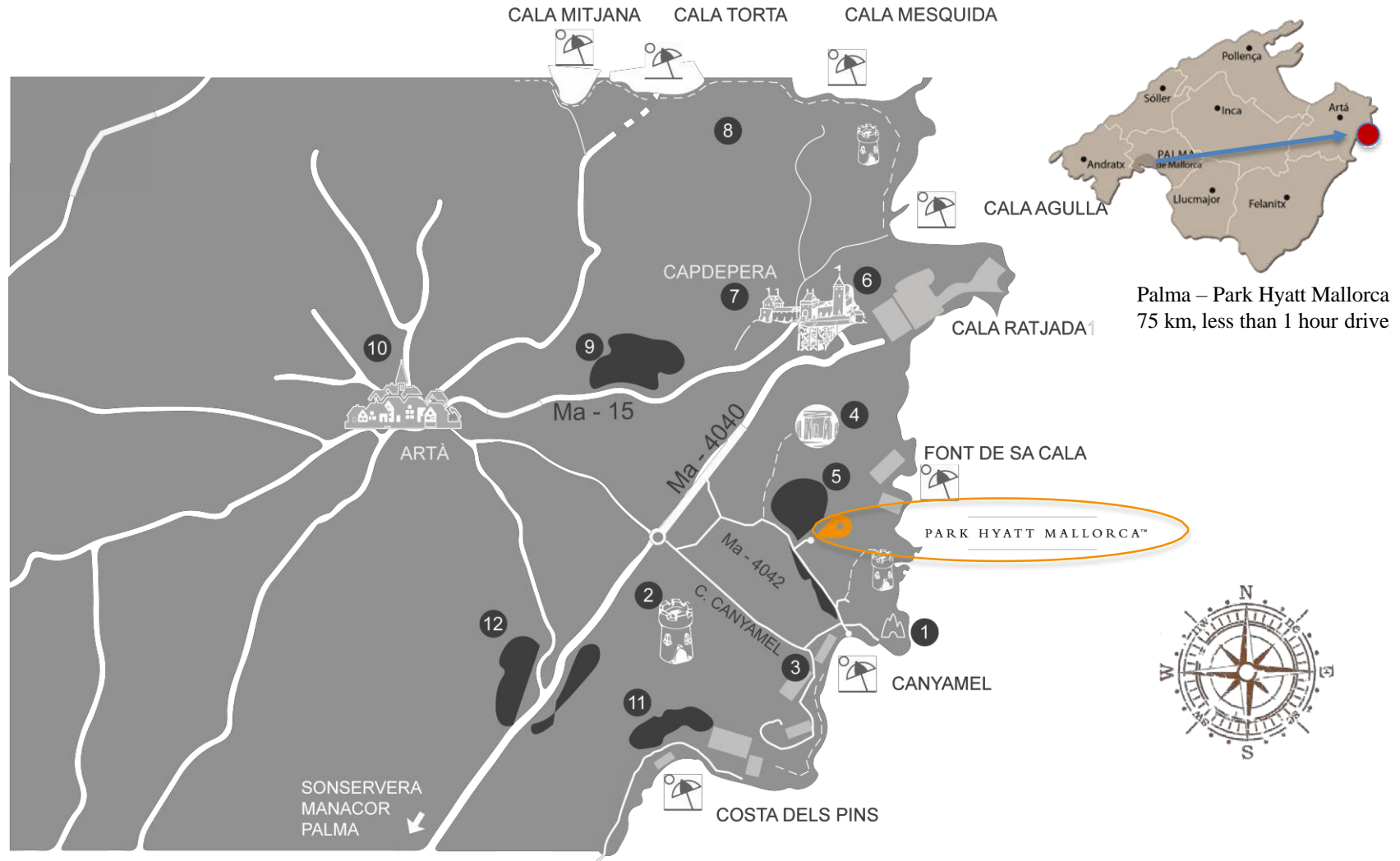

- |                       |                          |                           |                              |
|-----------------------|--------------------------|---------------------------|------------------------------|
| 1 – ARTÀ CAVES        | 4 – CLAPER DES GEGANTS   | 7 – CAPDEPERA TOWN        | 10 – ARTÀ TOWN               |
| 2 – TORRE DE CANYAMEL | 5 – CANYAMEL GOLF COURSE | 8 – LLEVANT NATURAL PARK  | 11 – SON SERVERA GOLF COURSE |
| 3 – CANYAMEL TOWN     | 6 – CALA RATJADA TOWN    | 9 – CAPDEPERA GOLF COURSE | 12 – PULA GOLF COURSE        |





## AND MUCH MORE...

- **SERENITAS SPA:** authentic treatments based on the island's minerals and herbs such as rosemary, lavender together with citric fruits, salt and aloe vera and exclusive products from ESPA.
- **GYM:** 24 hours
- At only 500 meters from Park Hyatt Mallorca, we find the **CAP VERMELL COUNTRY CLUB**, with an indoor semiolympic swimming pool, a fitness center, 2 tennis courts, 4 paddle tennis courts, etc.
- **YOGA** and more activities at the hotel.





# OUTSIDE ACTIVITIES

- GOLF
- CYCLING
- SAILING
- AIR BALLOON
- HORSEBACK RIDING
- WATER SPORTS
- WINE & OIL TASTING
- HIKING
- CULTURAL GUIDE EXCURSIONS

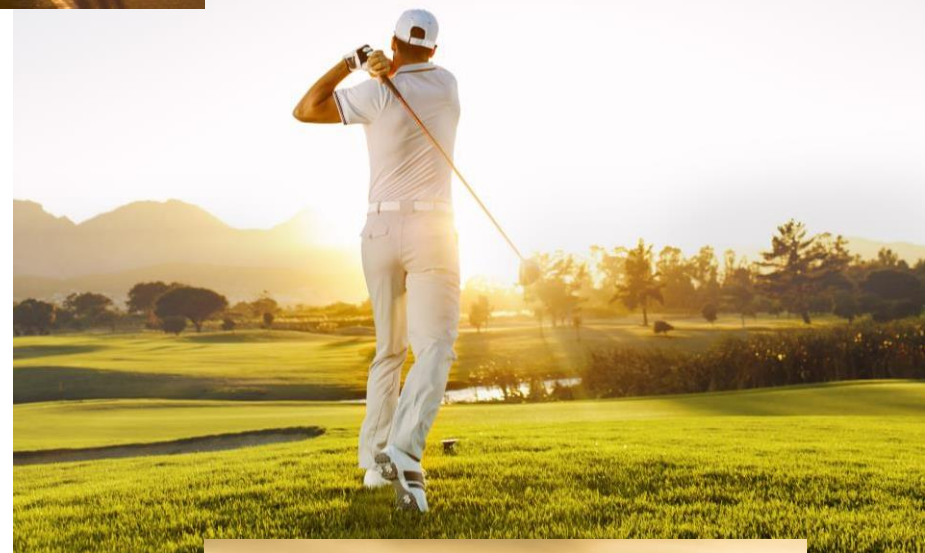





HYATT REGENCY  
AMSTERDAM



HYATT  
REGENCY  
AMSTERDAM

HYATT REGENCY AMSTERDAM  
Sarphatistraat 104,  
Amsterdam, Netherlands, 1018 CV,  
T +31 (0)20 554 1234  
amsterdam.regency.hyatt.com  
amsterdam.regency@hyatt.com  
@hyattregencyams #AtHyattRegency

The HYATT trademark and related marks are trademarks of Hyatt Corporation or its affiliates. ©2018 Hyatt Corporation. All rights reserved.





## Make the most of amsterdam

In the centre of Amsterdam, bordering the exciting east neighbourhood, five star Hyatt Regency Amsterdam connects business with pleasure and the city with nature, a BREEAM Excellent urban oasis minutes from Amsterdam's iconic sites. Relax amidst the hotel's 'living' décor, make yourself at home in spacious guestrooms, hold fruitful meetings in energizing spaces, savour Indonesian cuisine & botanical cocktails, or, slip away to soak up the local culture.

### ACCOMMODATIONS

211 spacious guestrooms (from 27sqm), including 15 suites, offer a refreshing ambience with elegant botanical inspired artwork and all the comforts & amenities to ensure an energizing yet productive stay. Regency Club access provides continental breakfast, all day snacks and evening cocktails & canapes.

- Standard & View rooms (from 27sqm)
- Regency Club rooms (30-40sqm)
- Club Deluxe rooms (40sqm)
- Suites (from 60sqm)
- Signature Spinoza Suite (126sqm)

### STANDARD AMENITIES

- Complimentary Wi-Fi.
- Generous workspace & numerous connection points.
- Luxury bath products & robes.
- Minibar, Mineral Water and Coffee & tea facilities.
- Flat-screen satellite TV with wireless connection.
- Safe & Individual climate control.

### RESTAURANTS & BARS

#### Mama Makan Restaurant

Warm & inviting neighbourhood restaurant serving authentic Indonesian food, including Mama's signature Rijsttafel. Grab a seat at the Chef's Table to watch Mama bring dishes to life from the open kitchen. @mamamakan

#### Bar

Vibrant lobby bar with outdoor terrace, serving botanical-inspired cocktails, signature classics and tasty bites. The communal table & lounge area offer the perfect spot for a daytime coffee or afternoon flex working.

#### Market

Choose from refreshing beverages and delicious snacks, along with local delicacies 24 hours a day.

### MEETINGS & EVENTS

From boardroom to brainstorm and conference to dinner, let your events unfold seamlessly in 517m<sup>2</sup> of flexible and modern event space.

- All meeting rooms bathed in natural daylight and equipped with high-tech AV & lighting solutions.
- 200 m<sup>2</sup> Ballroom with pre-function Foyer area.
- The Foyer, a breathtaking space with grand entrance, an impressive stage for your next social event.
- Three beautifully appointed meeting rooms (A, B, C) well equipped for events accommodating up to 70 guests.
- Awarded the BREEAM Excellent certificate for sustainability ensuring your meetings take place mindfully.



### RECREATIONAL FACILITIES

#### 24 Hour Fitness Centre

Fully-equipped gym offering the latest freestyle & fitness equipment, towels, water & fresh fruit.

#### Wellness Area

Rest and recuperate with steam room, sauna & experience shower.

#### Jogging trails

A variety of jogging trails through the city, Oosterpark & Plantage are available.

#### Pool Table

Challenge friends to a game of pool with delicious cocktails & bites at the bar.

#### Communal Table

Enjoy your morning coffee, or afternoon flex-working in the 'living' lobby.

### TRANSPORTATION

- City Centre - 1,9 km / 5 min car / 10 min walk
- Central Train Station - 3,6 km / 8 min public transport
- Schiphol Airport - 21,1 km / 20 min car
- RAI Convention Centre - 4,4 km / 9 min car

24 hour secure car park, limousine & transfers on request

### LOCAL ATTRACTIONS

- Nature: Hortus Botanicus, Artis Royal Zoo, Oosterpark
- Culture: Theatre Carré, National Opera & Ballet, Tropenmuseum, Rembrandt House, Rijksmuseum, Hermitage & National Maritime Museum
- Business: Amstel Business Park, South Axis & RAI Convention Centre





HYATT REGENCY Amsterdam  
Sarphatistraat 102 - 104  
1018 GV Amsterdam  
Netherlands

T +31 (0) 20 554 1234  
[amsterdam.regency@hyatt.com](mailto:amsterdam.regency@hyatt.com)  
[amsterdam.regency.hyatt.com](http://amsterdam.regency.hyatt.com)  
[@hyattregencyams](https://www.instagram.com/hyattregencyams)



#### ACCOMMODATIONS

- 211 well-appointed spacious guestrooms & suites (from 27 m<sup>2</sup>), including 13 Regency Suites, one Regency Executive suite and one Presidential Spinoza Suite
- Regency Club Lounge on the 2nd floor. Regency Club rooms & suites offer access to the Lounge, serving continental breakfast, all-day snacks and evening cocktails & canapes

#### All Accommodations Offer

- Complimentary Wi-Fi
- Spacious bathroom with amenities, robes and hairdryer
- Dedicated working area
- Flat-screen satellite TV with wireless streaming connection
- Marie Stella Maris mineral water
- Dual-line telephone and voicemail
- In-room safety deposit box
- Individual climate control
- Coffee & Tea making facilities
- Minibar

#### RECREATIONAL FACILITIES

- Stay on track with your fitness thanks to the fully-equipped 24 hour Fitness Centre
- Rest & Recuperate with steam room, sauna and experience shower in the Wellness Area
- Challenge peers to a game of pool with cocktails & bites at the bar
- Enjoy your morning coffee or afternoon flex-working at the "living" Communal Table
- A variety of jogging trails through the city and nearby Oosterpark are also available

#### AMENITIES

- 24-hour room service
- 24-hour concierge service
- multilingual staff
- recharge room
- 24-hour Fitness Centre & Wellness Area
- Laundry/dry cleaning
- Underground car park and valet service
- Business Centre services
- Babysitting service on request
- Limousine service and airport transfer upon request

#### RESTAURANTS & BAR

- **Mama Makan Restaurant** — Warm & inviting neighbourhood restaurant serving authentic Indonesian food, including Mama's signature Rijsttafel. A seat at the Chef's Table offers diners a front row seat to the vibrant open kitchen
- **Bar** — Vibrant lobby bar with outdoor terrace, serving botanical-inspired cocktails, signature classics and tasty bites. The communal table & lounge area offer the perfect spot for a daytime coffee, meeting or afternoon flex working
- **24/7 market** — Provides refreshing beverages and delicious pastries and bakery items along with local delicacies

#### MEETINGS & EVENTS

- 517 m<sup>2</sup> of flexible & modern event space
- 200 m<sup>2</sup> ballroom with vibrant pre-function Foyer area
- The Foyer, a breathtaking space with grand entrance, an impressive stage for your next social event
- Three beautifully appointed meeting rooms (A, B, C) for events accommodating up to 70 guests
- All meeting rooms bathed in natural daylight and equipped with high-tech AV & lighting solutions
- Awarded the BREEAM Excellent certificate for sustainability

#### LOCATION

Hyatt Regency Amsterdam is situated in Amsterdam's cultural garden, the Plantage, bordering the city's hip & exciting east neighborhood. This area, in the centre of Amsterdam is home to the city's botanical gardens and numerous museums and cultural institutions. The hotel is just 5 minutes' from the nearest metro station and close to Amsterdam's main business districts and the RAI convention center.

#### TRANSPORTATION

- City Centre - 1,9 km / 5 min car / 10 min walk
- Central train station - 3,6 km / 8 min public transport
- Schiphol Airport - 21,1 km / 20 min car
- RAI Convention Centre - 4,4 km / 9 min car

#### POINTS OF INTEREST

- **Nature:** Hortus Botanicus, Artis Royal Zoo, Oosterpark
- **Culture:** Theatre Carré, National Opera & Ballet, Tropenmuseum, Rembrandt House, Rijksmuseum, Hermitage & National Maritime Museum
- **Business:** Amstel Business Park, South Axis & RAI Convention Centre

#### VISITOR INFORMATION

- Language: Dutch
- Currency: Euro (EUR)
- Climate: Amsterdam has a mild climate and can be best visited in spring or summer. temperatures vary from 1°C in January to 21°C in summer (average). Rain can be expected throughout the entire year

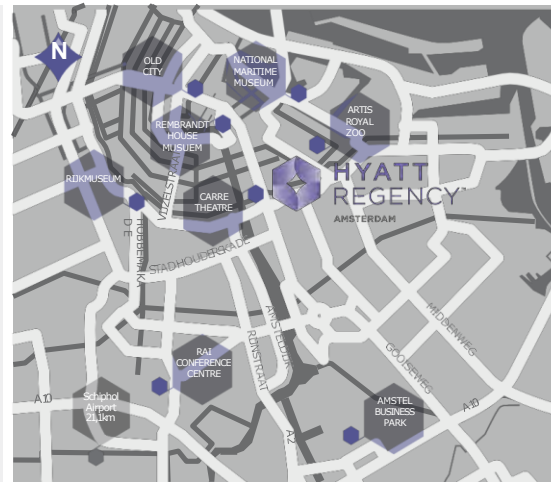

HYATT REGENCY AMSTERDAM  
 Sarphatistraat 104  
 1018GV Amsterdam  
 The Netherlands  
 T +31 20 554 1234  
[amsterdam.regency@hyatt.com](mailto:amsterdam.regency@hyatt.com)  
[amsterdam.regency.hyatt.com](http://amsterdam.regency.hyatt.com)



## CAPACITY CHART



Room Name	Room Dimensions L x W x H	Room Size Sq. Ft. / Sq. M.	Banquet	Reception	Theatre	Classroom	Boardroom	U-Shape	Cabaret
BALLROOM	159m x 118m x 3.4m	2055 / 191	128	224	216	84	38	44	112
MEETING ROOM AB	122m x 5.8m x 3.35m	851 / 80	48	90	72	28	36	28	40
Meeting Room A	7m x 5.8m x 3.35m	495 / 46	24	50	40	16	20	16	24
Meeting Room B	5.2m x 5.8m x 3.35m	366 / 34	-	40	24	12	16	-	-
MEETING ROOM C	8.2m x 5.5m x 3.25m	549 / 51	12	40	-	-	12	-	-
FOYER	165m x 9.5m x 5m	2099 / 195	56	150	-	-	-	-	-



HYATT REGENCY AMSTERDAM  
Sarphatistraat 104  
1018GV Amsterdam  
The Netherlands  
T +31 20 554 1234  
[amsterdam.regency@hyatt.com](mailto:amsterdam.regency@hyatt.com)  
[amsterdam.regency.hyatt.com](http://amsterdam.regency.hyatt.com)



FLOOR PLAN  
Ground Floor

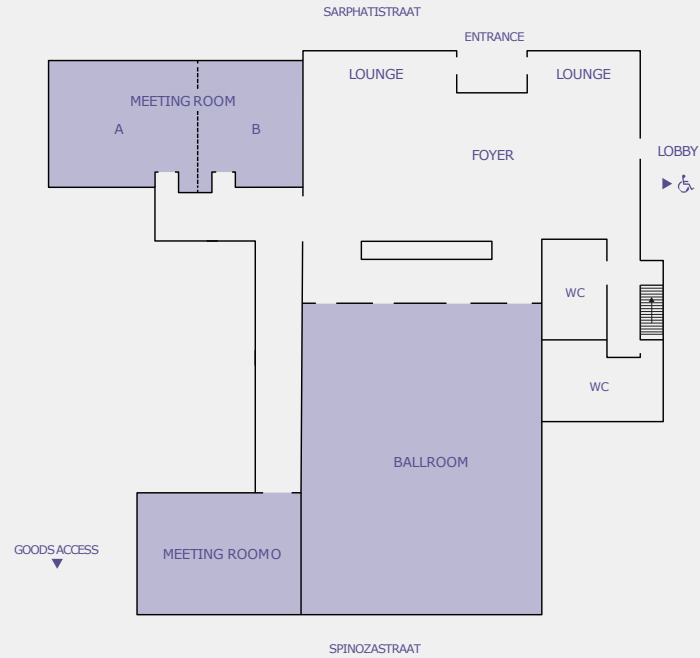



ANDAZ™ | LONDON  
LIVERPOOL STREET



# ANDAZ LONDON NEIGHBOURHOOD

BRICK LANE E.I.

ব্রিক লেন

BE BAD UNTIL YOU'RE GOOD  
AND GOOD UNTIL YOU'RE GREAT.

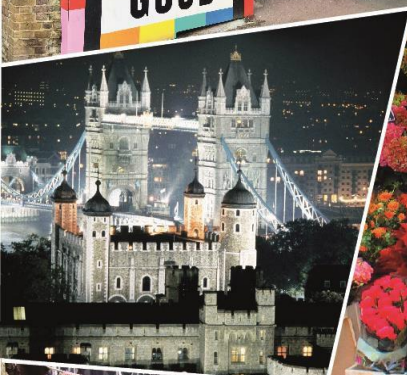



# HOTEL OVERVIEW

## 267 Rooms

- 98 Andaz Queens
- 107 Andaz Kings
- 44 Andaz Large Kings
- 8 Andaz Suites
- 7 Andaz Large Suites

## Meeting & Event Spaces

- 15 Rooms
- 18,000 Sq. Ft

## Key Selling Features

- Located in heart of City of London & East London
- 10 mins from West End & Shoreditch
- 7 restaurants & bars
- 15 meeting rooms
- Cross Rail in 2018 (LHR in 30 mins)
- Complimentary Andaz Amenities
  - WI-FI in Guestrooms & Meeting spaces
  - Welcome Beverage
  - Mini-Bar included (non-alcoholic)
  - Unlimited local phone calls
  - Andaz Lounge drinks & snacks
  - 24 hour access to Health Club





# UNIQUE DESIGN

Formerly the Great Eastern Hotel, Andaz London Liverpool Street is housed in a beautiful redbrick building dating back to 1884 – a **21<sup>st</sup> century masterpiece** with a seamless blend of **traditional and contemporary features** throughout.



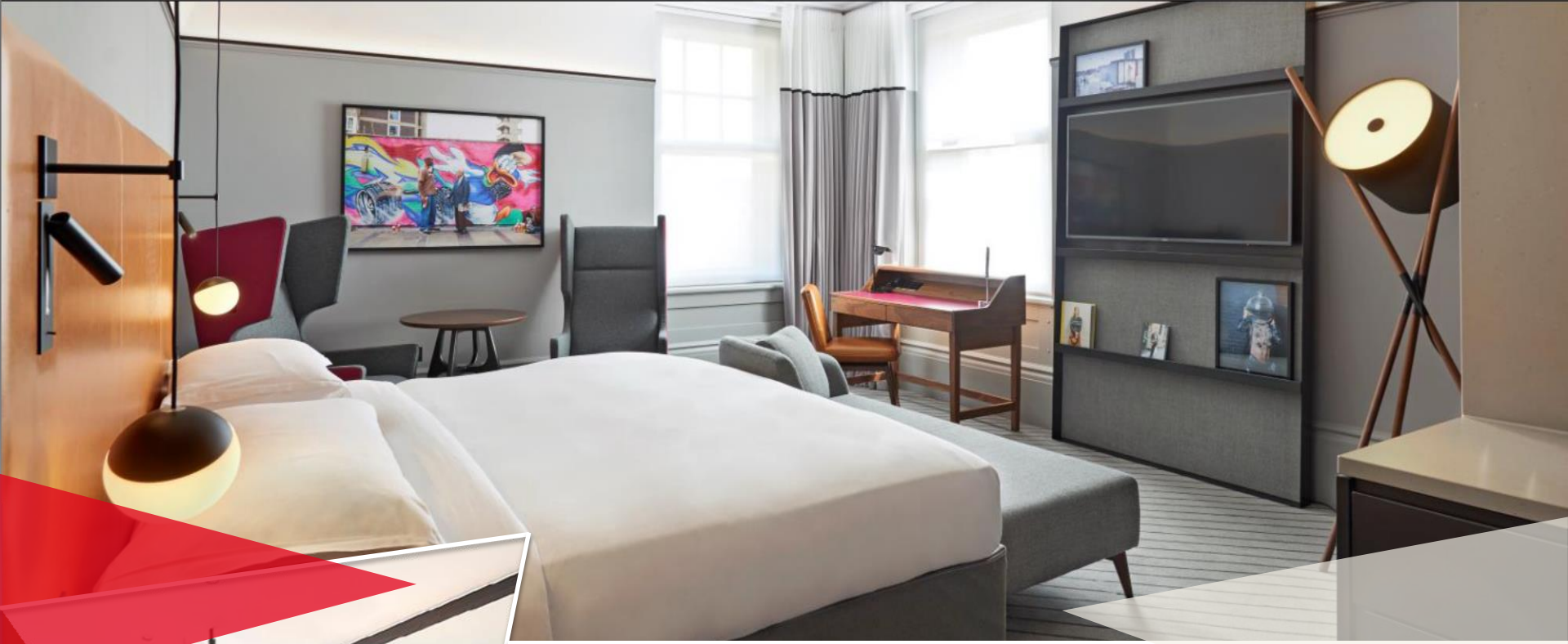

## **ANDAZ** ACCOMMODATION

### Room amenities

- 60" LCD plasma screen TV
- Upscale bath amenities by Ren
- Yukata robes
- Laptop size safe
- 24 hour room service

### Suite amenities

- Complimentary bottle of wine
- Fruit platter
- Nespresso machine
- Luxurious bathrobes



# DRINKING & DINING

*Dining at Andaz will tempt any palate with  
7 restaurants & bars across the hotel*







 *Dining at Andaz will tempt any palate from  
British pub fare to traditional Japanese*





Indulge in the **1901 Wine Lounge** or savour a cocktail in the **Front Room of Rake's**



# HEALTH CLUB

24-hour Gym and Health Club





# MEETINGS & EVENTS

*Andaz London features 15 distinctly unique & diverse private dining and event spaces.*





# 1901 BALLROOM







*GREAT EASTERN*  
& GALLERY

**BISHOPSGATE**

& CHANCERY







**FENCHURCH**



# EXCHANGE







*BREAKOUT*

ROOMS



## MASONIC TEMPLE

*Recently voted by Forbes Life as one of the '5 most dramatic and surprising private Rooms in London', the Grade 1 listed Masonic Temple provides an opulent setting for private events up to 60 people. Zodiac ceiling, listed marble columns and throne-like chairs results in a venue with a WOW factor that will truly impress.*



# ANDAZ STUDIO



## ROOM DIMENSIONS AND CAPACITIES

		SQUARE METRES	SQUARE FEET	BANQUET	RECEPTION	THEATRE	CABARET	CLASSROOM	BOARDROOM	U-SHAPE	HOLLOW SQUARE	DINNER DANCE
1901	17.5 x 17.1 x 5.3 / 57' x 56' x 17'4"	299	3,221	180	180	160	120	72	32	42	42	150
1901 WINE LOUNGE	20.1 x 7.1 x 4 / 65.9' x 23.3' x 13'1"	259	2,781	—	100	—	—	—	—	—	—	—
GREAT EASTERN	21.4 x 10.4 x 3.4 / 70' x 34' x 11'2"	222	2,389	220	300	250	120	120	60	60	80	160
GALLERY	29.6 x 15.9 x 3.6 / 97' x 52' x 11'9"	470	5,059	—	200	—	—	—	—	—	—	—
BISHOPSGATE	9.8 x 9.3 x 5 / 32' x 31' x 16'4"	91	979	70	100	80	48	54	24	27	36	70
CHANCERY	8.1 x 5.9 x 5 / 27' x 19' x 16'4"	48	517	—	50	—	—	—	—	—	—	—
FENCHURCH	14.1 x 7.4 x 4.5 / 46' x 24' x 14'9"	104	1,119	60	100	60	40	39	32	30	36	40
MINORIES	10.3 x 7.1 x 3.6 / 34' x 23' x 11'9"	73	786	40	50	50	24	24	24	21	24	—
STUDIO	7.8 x 15 x 2.2 / 26' x 49' x 7'2"	117	1,259	48	80	56	36	20	26	18	24	32
TEMPLE	12.5 x 9 x 5 / 41' x 30' x 16'4"	112	1,206	44	60	40	24	—	22	15	18	—
MOORGATE	6.1 x 6.5 x 2.9 / 20' x 21' x 9'6"	40	431	16	20	24	18	9	15	9	12	—
EXCHANGE	6.4 x 5.3 x 5 / 21' x 17' x 16'4"	34	366	16	—	—	—	—	16	—	—	—
BROADGATE	6.6 x 6.8 x 2.9 / 22' x 22' x 9'6"	45	484	14	—	—	—	—	14	—	—	—
MONUMENT	6.1 x 3.3 x 2.9 / 20' x 11' x 9'6"	20	215	10	—	—	—	—	10	—	—	—
LEADENHALL	5.3 x 3.2 x 2.9 / 17' x 10' x 9'6"	17	183	8	—	—	—	—	8	—	—	—
SPITALFIELDS	5.3 x 3.2 x 2.9 / 17' x 10' x 9'6"	17	183	8	—	—	—	—	8	—	—	—





THANK  
YOU

ANDAZ | LONDON  
LIVERPOOL STREET



HYATT CENTRIC<sup>®</sup>  
THE LIBERTIES DUBLIN



The background of the slide is a light gray map of the Liberties area in London, showing a complex network of streets and building footprints. A solid orange horizontal banner is centered across the middle of the slide, containing the title text in white.

# THE LIBERTIES

# The Liberties

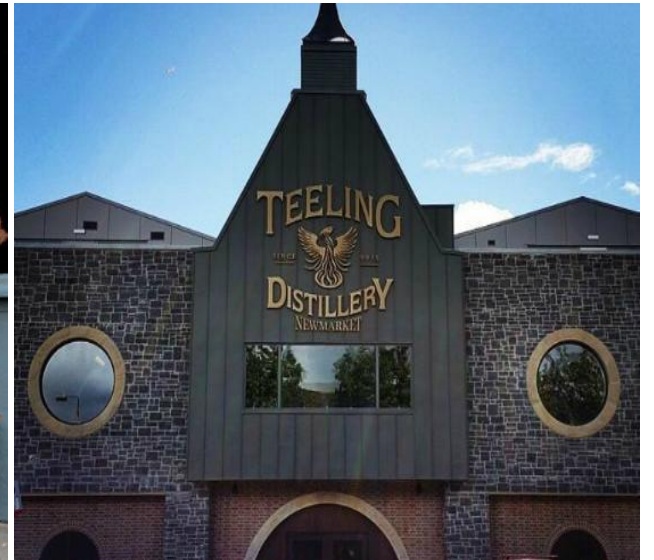



# The Liberties and the City





# The Liberties

## ATTRACTIONS



Dublne - "Hop on Hop off" tourist experiences

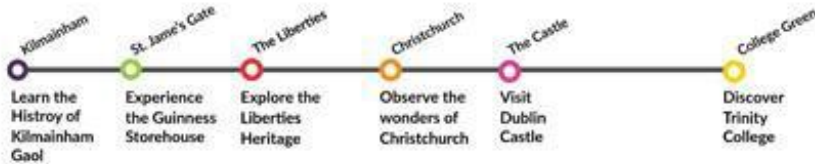

### Main Attractions:

- 1 St. Patrick's Cathedral
- 2 Christ Church Cathedral
- 3 Dublin Castle
- 4 St. Stephen's Green
- 5 Guinness Storehouse
- 6 Teolings Distillery
- 7 Chester Beatty Library
- 8 Temple Bar
- 9 Galety Theatre
- 10 Vicar Street
- 11 Trinity College
- 12 Kilmainham Gael
- 13 Old Jameson Distillery



## ACCESSIBILITY

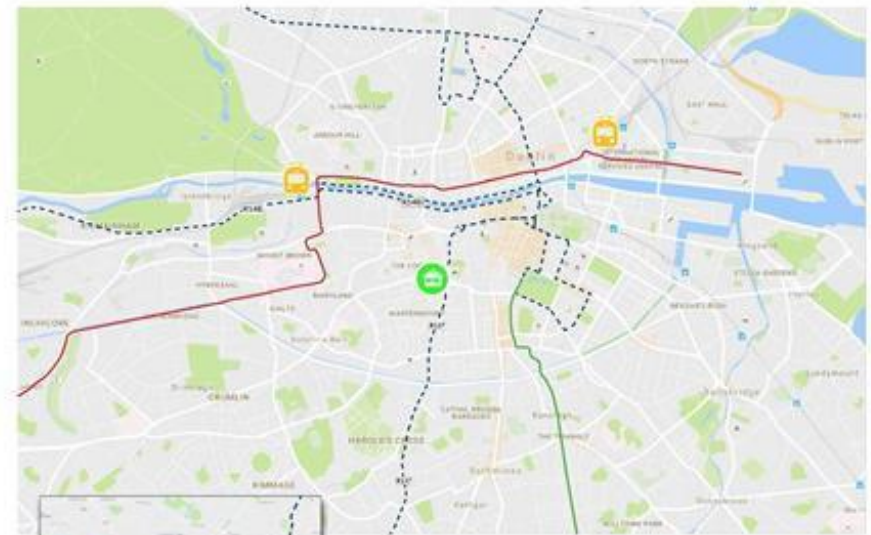





# HYATT CENTRIC THE LIBERTIES DUBLIN

# Exterior





# Checking in





# Lobby Lounge





# The Restaurant & Lounge





# Liberties Gate Bar





# The Bedroom (234 bedrooms total)



# The Bedroom (234 bedrooms total)







# Meeting Space - boardroom





# Event Space – banquet (max 120)



# Ground floor plan

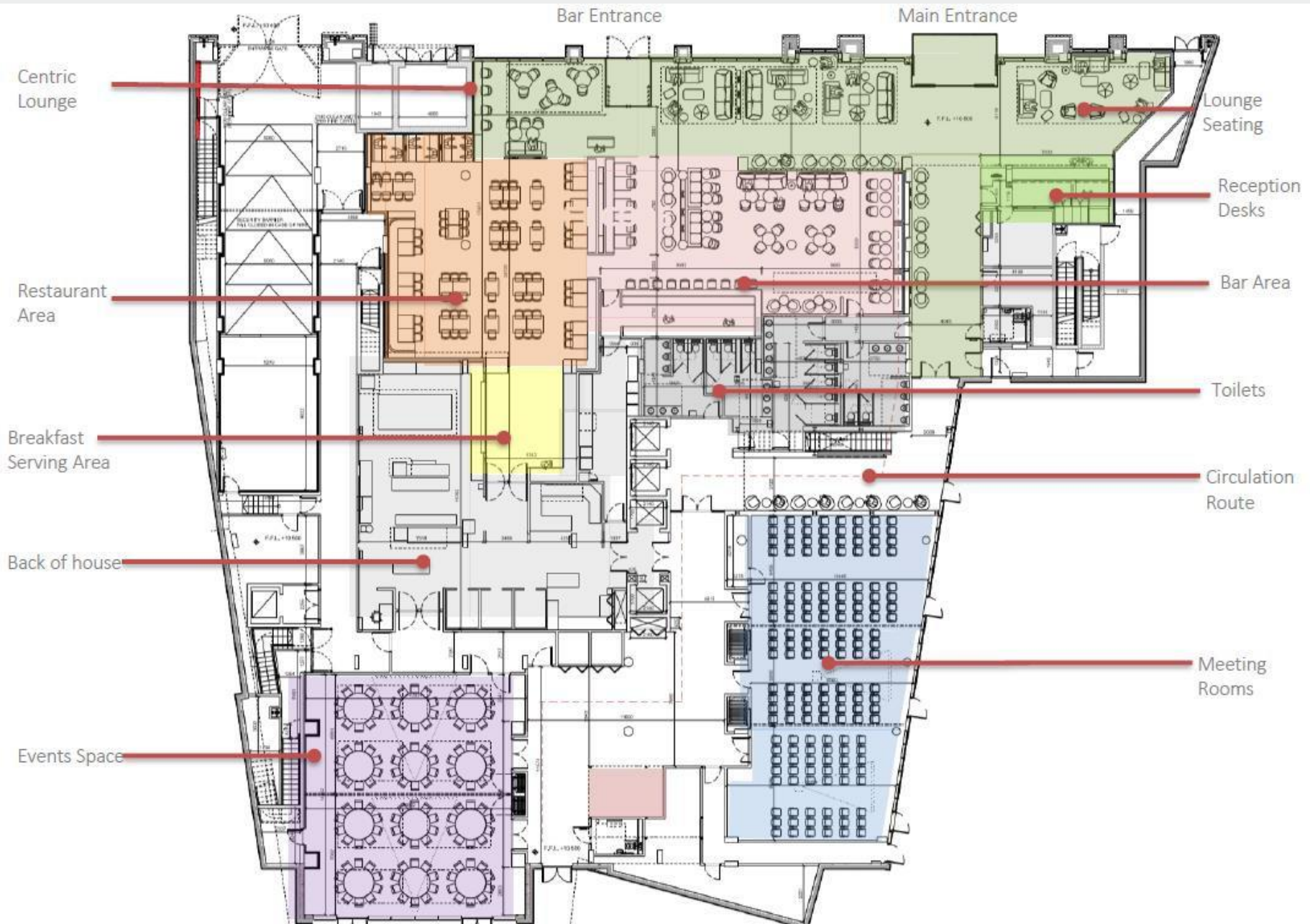



# Capacities and dimensions



Room Name	Room Dimensions (Metres) L x W x H	Room Dimensions (Feet & Inches) L x W x H	Room Size Sq. M.	Room Size Sq. Ft.	Banquet (Rnds of 10)	Reception	Theater	Classroom	Conference/ Boardroom	U-Shape	Crescent (Cabaret / Half moon)
<b>GROUND FLOOR</b>											
Dean	10.5 x 20.5 x 3m	34' 5" x 67' 3" x 10'	215.25	2317	130	250	170	80	44	40	65
Dean - Salon 1	10.5 x 6.5 x 3m	34' 5" x 21' 4" x 10'	68.25	735	40	90	55	25	24	20	25
Dean - Salon 2	9.5 x 6 x 3m	31' 2" x 19' 8" x 10'	57	614	40	70	45	20	18	16	20
Dean - Salon 3	10 x 7 x 3m	32' 9" x 23' x 10'	70	753	40	90	55	25	14	20	25
Cork	14.5 x 12 x 3m	47' 7" x 39' 4" x 10'	174	1873	120	200	150	70	38	30	60
Cork - Salon 1	7 x 12 x 3m	23' x 39' 4" x 10'	84	904	50	100	70	30	28	16	25
Cork - Salon 2	7 x 12 x 3m	23' x 39' 4" x 10'	84	904	50	100	70	30	28	16	25



HYATT CENTRIC<sup>®</sup>  
THE LIBERTIES DUBLIN





# HYATT CENTRIC™

THE LIBERTIES DUBLIN

Dean Street,  
The Liberties,  
Dublin 8

hyattcentricthelibertiesdublin.com  
T. +353(86) 028 8871

#### ACCOMMODATIONS

- 234 guest rooms including an expansive Presidential Suite, 8 Executive Suites 177 twin-able rooms
- 100% smoke free environment
- Complimentary high-speed wireless internet access
- 50-inch flat screen TV
- Personalized in room streaming entertainment
- Telephone with voicemail
- Individually controlled air-conditioning
- USB charging power sockets
- City views and St Patrick Cathedral views available
- Hair dryer, bath robes, slippers
- In-room refrigerator, in-room safe
- Nespresso coffee and tea machine

#### SERVICES & FACILITIES

- Our concierge will organise your full stay from transportation to the booking of restaurants and visitor attractions
- Cycling the city concierge
- Multilingual staff
- Covered parking
- Transportation to/from local international airport & train stations under reservation
- Multilingual staff

#### CONFERENCES & MEETINGS

- Dean meeting room of 215 sqm (dimensions: 10.50x20.50x3.00) which can welcome 170 persons theatre style, 250 persons for a cocktail reception. Note: this room is divisible into 3 smaller rooms
- Cork meeting room of 174sqm (dimensions: 14.50x12.00x3.00) which can welcome 150 persons theatre style, 200 persons for a cocktail reception. Note: this room is divisible into 2 smaller rooms
- High-speed wired and wireless internet
- Full audio and visual services

#### RESTAURANTS, BARS & LOUNGE

- **Liberties Gate Bar:** Deeply rooted in it's neighbourhood, this bar celebrates it's central location surrounded by Ireland's top whiskey distilleries and some very well known breweries..
- **The Restaurant:** Specializing in local, natural and organic-inspired dishes. Especially selected winelist from all around the world.
- **Craft Specialty Coffee** Roasted in Dublin especially for Hyatt Centric The Liberties Dublin we promise that you will love our coffee

#### RECREATIONAL FACILITIES

- **24 hour fitness Suite** Providing the latest in cardio equipment, free weights and machines this 24 hour accessible gym is the best place to start your energetic day!

#### LOCATION

Located in the famous Liberties neighbourhood of Dublin, across the street from St Patrick's Cathedral. This is the perfect place to explore Dublin's top tourist attractions but also go off the beaten track and meet Dublin's real character.

Our hotel has a buzz of energy about it. The neighbourhood lives within it giving you a flavour of what awaits your discovery in the city.

#### TRANSPORTATION

- Dublin airport: 13km -20-30 minutes by car
- Heuston Railway Station: 2km - 5-10 minutes by car
- Connolly Railway Station: 3km -10-15 minutes by car
- Green Luas at St Stephen's Green: 1km -10 mins by foot

#### POINTS OF INTEREST

- Within 10 minutes walk of the hotel:
- Guinness Storehouse
  - St Patrick's Cathedral
  - Christchurch Cathedral
  - Temple Bar
  - Francis Street for antique shopping
  - Grafton Street for high street shops
  - South William district for local independent boutiques and hip bars
  - Trinity College to see the Book of Kells and the Long Library - it will change your life!
  - The Liberties is home to Irish Whiskey: Teelings Distillery and many more are within 5 minutes walk of the hotel.

#### VISITOR INFORMATION

**Language:** English

**Currency:** Euro

**Climate:** Dublin has a mild temperate climate meaning it is never too hot or too cold! It does rain on occasion so always come prepared with a light jacket in summer and a warm coat in winter.

**Visa:** Please refer to your local travel consultant prior to travel

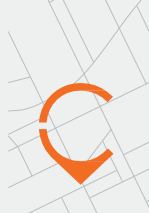

FLOOR PLANS

DEAN

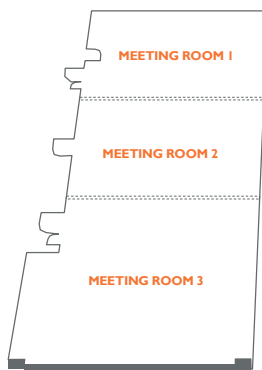

CORK

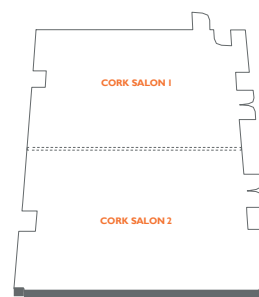

ROOM CAPACITIES AND DIMENSIONS



Room Name	Room Dimensions (Metres) L x W x H	Room Dimensions (Feet & Inches) L x W x H	Room Size Sq. M.	Room Size Sq. Ft.	Banquet (Rnds of 10)	Reception	Theater	Classroom	Conference/Boardroom	U-Shape	Crescent (Cabaret / Halfmoon)
<b>GROUND FLOOR</b>											
Dean	10.5 x 20.5 x 3m	34' 5" x 67' 3" x 10'	215.25	2317	130	250	170	80	44	40	65
Dean Salon 1	10.5 x 6.5 x 3m	34' 5" x 21' 4" x 10'	68.25	735	40	90	55	25	24	20	25
Dean Salon 2	9.5 x 6 x 3m	31' 2" x 19' 8" x 10'	57	614	40	70	45	20	18	16	20
Dean Salon 3	10 x 7 x 3m	32' 9" x 23' x 10'	70	753	40	90	55	25	14	20	25
Cork	14.5 x 12 x 3m	47' 7" x 39' 4" x 10'	174	1873	120	200	150	70	38	30	60
Cork Salon 1	7 x 1 x 3m	23' x 39' 4" x 10'	84	904	50	100	70	30	28	16	25
Cork Salon 2	7 x 1 x 3m	23' x 39' 4" x 10'	84	904	50	100	70	30	28	16	25